



Los Angeles County Committee on School District Organization

Los Angeles County Education Center • 9300 Imperial Highway • EC Annex • Downey, CA 90242-2890

December 28, 2001

2002

County Committee Members

First Supervisorial District

John Nunez
Frank Ogaz, *Vice Chairperson*

Second Supervisorial District

Joan Jakubowski
Errick R. Lee

Third Supervisorial District

Brenda Gottfried
AJ Willmer

Fourth Supervisorial District

Frank Bostrom, *Chairperson*
Owen H. Griffith

Fifth Supervisorial District

Kathryn Blankinship
Sheldon Baker

At Large

Lloyd de Llamas

Gregory G. Magnuson
Secretary
(562) 922-6144



Los Angeles County
Office of Education

Ms. Lydia Rodriguez, Chief Petitioner
Citizens For A Wiseburn Unified School District
5164 West 131st Street
Hawthorne, CA 90250

Dear Ms. Rodriguez:

Proposal to Form a Wiseburn Unified School District (USD)

In accordance with Education Code (EC) §35705, the Los Angeles County Committee on School District Organization (County Committee) has scheduled a public hearing concerning the subject petition.

Enclosed are the following related documents for your information:

1. Notice of Public Hearing (pursuant to EC §35705) to be held on January 23, 2002.
2. Agenda for the public hearing.
3. Public Hearing Agenda Guidelines.
4. Information on the proposed formation pursuant to EC §35705.5(b).
5. Directions to the public hearing.

At least ten days prior to the public hearing, the Los Angeles County Office of Education (LACOE) will publish the Notice in a newspaper of general circulation within the school district. At this time, it is anticipated that the Notice will be published in the Daily Breeze in English.

If there is a need to publish the Notice in additional newspaper(s) and language(s), please notify our office no later than **January 7, 2002**.

If you have questions or concerns, please call me at (562) 922-6144.

Sincerely,

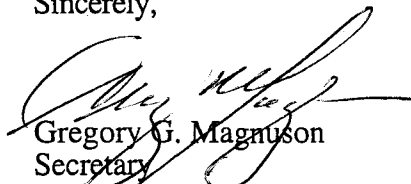
Gregory G. Magnuson
Secretary

GGM/DGV:mb
Enclosures

Ms. Lydia Rodriguez, Chief Petitioner
December 28, 2001
Page 2

cc: Dr. Lopez, Centinela Valley Union High SD
Mr. Carrington, Hawthorne SD
Dr. Condon, Lawndale SD
Dr. McDaniel, Lennox SD
Dr. Brann, Wiseburn SD
Mr. Nakamura, Citizens For A Wiseburn USD
Mr. Peterson, Citizens For A Wiseburn USD
Dr. Winters, Caldwell Flores Winters, Inc.
Ms. Curtis, Los Angeles County Counsel
Ms. Simons, LACOE
Mr. Villanueva, LACOE

**LOS ANGELES COUNTY COMMITTEE
ON SCHOOL DISTRICT ORGANIZATION
(COUNTY COMMITTEE)**

NOTICE OF PUBLIC HEARING

Pursuant to Education Code §35705, the County Committee will conduct a public hearing on a petition that proposes to form a Wiseburn Unified School District from existing territory of the Wiseburn SD. The proposed territory for reorganization currently lies within the boundaries of the Centinela Valley Union High SD.

DATE:	Wednesday, January 23, 2002
TIME:	7:30 p.m.
LOCATION:	Richard Henry Dana Middle School Auditorium 13500 Aviation Boulevard Hawthorne, CA 90250

NOTE: Language translation services and American Sign Language (ASL) interpreters will be provided with a minimum notice of three business days prior to the public hearing. Posting or distribution of banners, leaflets, handouts, or other media or communications, which serve to promote or discourage specific points of view, are prohibited inside the hearing room. For additional information call (562) 940-1645.

**LOS ANGELES COUNTY COMMITTEE ON
SCHOOL DISTRICT ORGANIZATION**

PUBLIC HEARING

on the Proposed Formation of a Wiseburn Unified School District (USD)

A G E N D A

Wiseburn School District
Richard Henry Dana Middle School
Auditorium
13500 Aviation Boulevard
Hawthorne, CA 90250

**Wednesday, January 23, 2002
7:30 p.m.**

- I. CALL TO ORDER—Chairperson
- II. FLAG SALUTE—Chairperson
- III. INTRODUCTIONS—Chairperson
- IV. HEARING ON PROPOSED FORMATION OF A WISEBURN USD
 - A. Explanation of the proposal, evaluation conditions, and process by Mr. Gregory G. Magnuson, Secretary.
 - B. Explanation of public hearing guidelines by Chairperson.
 - C. Testimony in the following order:
 1. Chief Petitioners
 2. Board members/superintendents of the affected districts
 - a. Wiseburn SD
 - b. Centinela Valley Union High SD
 3. Other Citizens
 - a. Proponents of proposal
 - b. Opponents of proposal
 - D. Summation/Closing Statements
 1. Chief Petitioners
 2. Board members/superintendents of the affected districts
 - E. Adjournment

**LOS ANGELES COUNTY COMMITTEE ON
SCHOOL DISTRICT ORGANIZATION
(COUNTY COMMITTEE)**

PUBLIC HEARING AGENDA GUIDELINES*

- I. Call to Order by the Chairperson
- II. Flag Salute
- III. Introduction of the County Committee by the Chairperson
 - Responsibilities/Missionno time limit
- IV. Hearing on Proposed Reorganization
 - A. Explanation of the Proposal, Evaluation Conditions and Process
by the Secretaryno time limit
 - B. Agenda Guidelines Explanation by the Chairpersonno time limit
 - C. Testimony in the following order:
 - 1. Chief Petitioners20 minutes maximum
 - 2. Representatives of the Affected Districts20 minutes maximum
(each district)
 - 3. Public Comment
 - a. Proponents.....45 minutes maximum; each
speaker limited to five
minutes maximum (time
may be shortened at the
discretion of the
chairperson)
 - b. Opponents.....45 minutes maximum; each
speaker limited to five
minutes maximum (time
may be shortened at the
discretion of the
chairperson)
 - D. Summation/Closing Statements
 - Chief Petitioners5 minutes each maximum
 - Affected Districts5 minutes each maximum
 - E. Adjournment

*Excerpt from "Policies of the Los Angeles County Committee on School District Organization."

**LOS ANGELES COUNTY COMMITTEE
ON SCHOOL DISTRICT ORGANIZATION**

PROPOSED FORMATION OF A WISEBURN UNIFIED SCHOOL DISTRICT

INFORMATION REQUIRED UNDER EDUCATION CODE (EC) §35705.5(B)

Pursuant to EC §35705.5(b), at least ten days before the public hearing(s) on the noted proposal, the Los Angeles County Committee on School District Organization is making the following information available to the public and the governing boards of both affected districts:

**1. THE RIGHTS OF THE EMPLOYEES IN THE AFFECTED DISTRICTS TO
CONTINUED EMPLOYMENT PURSUANT TO EC §35555, *et seq.***

Certificated Employees

The reorganization will not affect the classification of certificated employees already employed by any school district affected. In general, certificated employees may choose to continue their employment with the existing district or become employed by the new district.

For further information on the rights of certificated employees, please refer to EC §35555 (copy attached).

Classified Employees

The reorganization will not affect the rights of classified employees to retain their salary, leaves, and other benefits. In general, classified employees will become employees of the new district unless they meet specified conditions to allow them to continue their employment with the existing district.

For further information on the rights of classified employees, please refer to EC §35556 (copy attached).

2. THE REVENUE LIMIT PER UNIT OF AVERAGE DAILY ATTENDANCE (ADA) FOR EACH AFFECTED DISTRICT AND THE EFFECT OF THE PETITION, IF APPROVED, ON SUCH REVENUE LIMIT

The 2000-01 revenue limit per unit of ADA for the Wiseburn SD was \$4,512.84. The 2000-01 revenue limit per unit of ADA for the Centinela Valley Union High SD was \$5,099.34. If the proposal were effectuated, the revenue limit for the Centinela Valley Union High SD would remain the same. Pursuant to EC §35735, the revenue limit per unit of ADA for the proposed Wiseburn USD would be calculated using a weighted average formula composed of ADA and revenue limits using figures from the second fiscal year prior to the fiscal year in which the reorganization would become effective. The reorganization would become effective no earlier than fiscal year 2003-04. Thus, the estimated revenue limit for the proposed new district would be expected to exceed \$4,512.84 per ADA.

3. WHETHER THE DISTRICTS INVOLVED WOULD BE GOVERNED, IN PART, BY PROVISIONS OF A CITY CHARTER, AND IF SO, IN WHAT WAY

The provisions of city charters do not govern either the Wiseburn SD or the Centinela Valley Union High SD. The proposed Wiseburn USD, if formed, would be governed by general law.

4. WHETHER THE GOVERNING BOARDS OF ANY PROPOSED NEW DISTRICTS WILL HAVE FIVE OR SEVEN MEMBERS

The governing board of the proposed Wiseburn USD would have five members.

5. A DESCRIPTION OF THE TERRITORY OR DISTRICTS IN WHICH THE ELECTION, IF ANY, WOULD BE HELD

If the State Board of Education (SBE) approves the proposal, an election would be called in territory deemed appropriate by the SBE.

6. WHERE THE PROPOSAL IS TO CREATE TWO OR MORE DISTRICTS, WHETHER THE PROPOSAL WILL BE VOTED ON AS A SINGLE PROPOSITION

The petition submitted under EC §35700(a) proposes that a single district, the Wiseburn USD, be created. Therefore, the proposal would be voted on as a single proposition within the territory as determined by the SBE.

7. WHETHER THE GOVERNING BOARD OF ANY NEW DISTRICT WILL HAVE TRUSTEE AREAS, AND IF SO, WHETHER THE TRUSTEES WILL BE ELECTED BY ONLY THE VOTERS OF THAT TRUSTEE AREA OR BY THE VOTERS OF THE ENTIRE DISTRICT

The method to be used for voting for the governing board of the proposed Wiseburn USD would be an at-large method. The new district would not have trustee areas.

8. A DESCRIPTION OF HOW THE PROPERTY, OBLIGATIONS, AND BONDED INDEBTEDNESS OF EXISTING DISTRICTS WILL BE DIVIDED

All real property and personal property and fixtures located within the boundaries of the proposed new district would become the property of the new district. All other property, funds and obligations, and bonded indebtedness would be divided among the districts in accordance with applicable provisions of the Education Code.

9. A DESCRIPTION OF WHEN THE FIRST GOVERNING BOARD OF ANY NEW DISTRICT WILL BE ELECTED AND HOW THE TERMS OF OFFICE WILL BE DETERMINED

The election of governing board members would be held on the same date as the election for determining whether the district should be formed. The three members receiving the highest number of votes would serve four-year terms. The two members receiving the next highest number of votes would serve two-year terms.

EDUCATION CODE SECTION 35555

The reorganization of any school district or districts shall not affect the classification of certificated employees already employed by any school district affected. Such employees shall have the same status with respect to their classification by the district, including time served as probationary employees of the district, after the reorganization as they had prior to it. If such reorganization results in the school or other place in which any such employee is employed being maintained by another district, any such employee, if a permanent employee of the district which formerly maintained such school or other place of employment, shall be employed as a permanent employee of the district which thereafter maintains the school or other place of employment, unless such employee elects prior to February 1 of the year in which the action will become effective for all purposes to continue in the employ of the first district.

If such employee is a probationary employee of the district which formerly maintained such school or other place of employment, he or she shall be employed by the district which thereafter maintains the school or other place of employment, unless such probationary employee is terminated by such district pursuant to Section 44948, 44949, or 44955, and, if not so terminated, his or her status with respect to classification by such district shall be the same as it would have been had the school or other place of employment continued to be maintained by the district which formerly maintained it. As used in this paragraph, "the school or other place in which any such employee is employed" and all references thereto, includes, but is not limited to, the school services or school program which, as a result of any reorganization of a school district, will be provided by another district, regardless of whether any particular building or buildings in which such schoolwork or school program was conducted is physically located in the new district and regardless of whether any new district resulting from such reorganization elects to provide for the education of its pupils by contracting with another school district until such time as the new district constructs its own facilities.

EDUCATION CODE SECTION 35556

(a) The reorganization of any school district, or districts, shall not affect the rights of persons employed in positions not requiring certification qualifications to retain the salary, leaves, and other benefits which they would have had if the reorganization had not occurred. These persons shall be treated in the manner provided in this section.

(b) All employees of every school district that is included in any other district, or all districts included in a new district, shall become employees of the new district.

(c) (1) When a portion of the territory of any district becomes part of another district, employees regularly assigned to perform their duties in the territory affected shall become employees of the acquiring district unless, in a manner consistent with relevant provisions of this code and with any applicable collective bargaining agreement, one of the following occurs:

(A) An employee elects to accept a vacant position, for which he or she qualifies, that the first district elects to fill.

(B) An employee elects to fill, by exercise of his or her rights of seniority under existing law or the collective bargaining agreement with the first district, a position, for which he or she qualifies, in the first district.

(C) An employee elects to have his or her name entered on a reemployment list of the first district.

(2) Employees whose assignments pertained to the affected territory, but whose employment situs was not in that territory, may elect to remain with the original district or become employees of the acquiring district.

(d) When the territory of any district is divided between, or among, two or more districts and the original district ceases to exist, employees of the original district regularly assigned to perform their duties in any specific territory of the district shall become employees of the district acquiring the territory. Employees not assigned to specific territory within the original district shall become employees of any acquiring district at the election of the employees.

(e) An employee regularly assigned by the original district to any school in the district shall be an employee of the district in which the school is located unless that employee elects to continue in the employ of the first district pursuant to subdivision (c).

(f) Except as otherwise provided in this section, nothing in this section shall be construed to deprive the governing board of the acquiring district from making reasonable reassignments of duties.

(g) The amendments to this section made during the 1999-2000 Regular Session of the Legislature shall apply only to school district reorganizations commenced on or after January 1, 2000.

Directions to Public Hearing

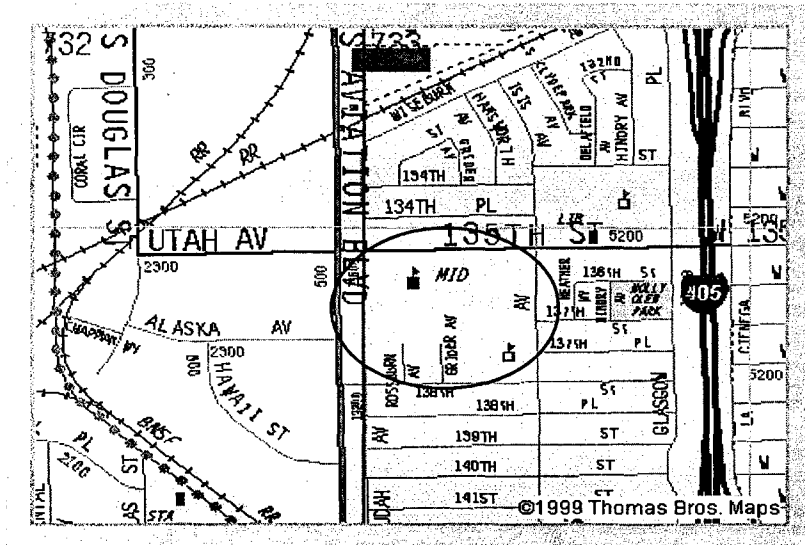

Area Map

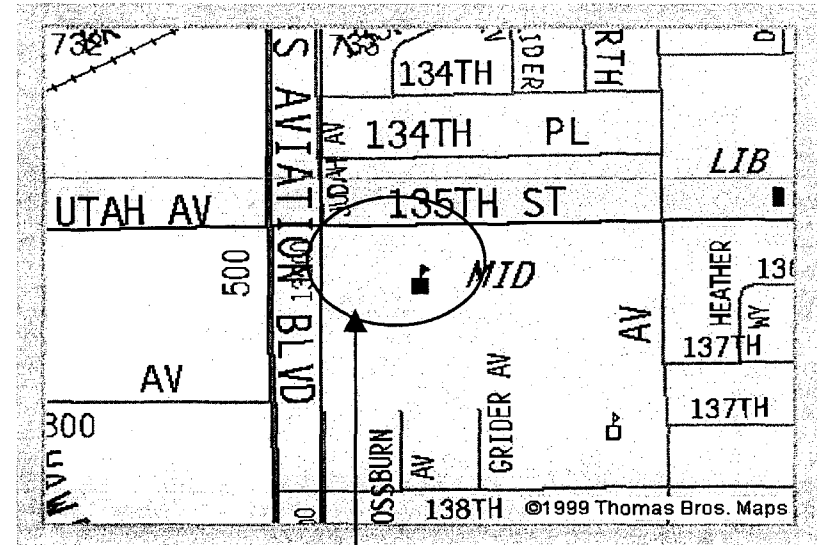

*Richard Henry Dana Middle School
13500 Aviation Boulevard
Hawthorne, CA 90250*

From the Los Angeles County Office of Education

- Century (105) Freeway West
- Exit Aviation Blvd
- Turn left (South) onto Aviation Blvd
- Turn Left (East) onto 135th St
- Immediately Turn Right into parking lot

County Committee members, please park in reserved parking spaces.