



**Exam : 9A0-036**

**Title : Adobe PhotoShop CS ACE Exam**

**Ver : 05.25.07**

---

**QUESTION 1:**

Which layer parameter can be saved when creating a Layer Comp?

- A.layer styles
- B.layer opacity
- C.layer stacking order
- D.layer blending mode

Answer: A

---

**QUESTION 2:**

Which items are saved as part of a workspace?

- A.tool settings and palette positions
- B.tool settings and keyboard shortcuts
- C.palette positions and keyboard shortcuts
- D.the positions of all open palettes and the toolbox

Answer: D

---

**QUESTION 3:**

Which parameter can you monitor in the Status Bar?

- A.the name of the active layer
- B.the document's color profile
- C.the name of the active document
- D.the document's modification date

Answer: B

---

**QUESTION 4:**

You want to paint a layer by using the Brush tool with an opacity setting of 50%.  
Where do you change the opacity setting?

- A.Status Bar
- B.Layer palette
- C.Brushes palette
- D.Tool Options Bar

Answer: D

---

**QUESTION 5:**

You have created several custom contours for Drop Shadow effects. You want to save the custom contours as a set while maintaining the default contours.

What should you do?

- A. from the Styles palette menu, choose Save Styles
- B. from the Layer palette menu, choose New Layer Set
- C. in the Preset Manager dialog box, select the contours and click on Save Set
- D. while editing contours in the Layer Style dialog box, choose Save Contours from the fly-out menu.

Answer: C

---

**QUESTION 6:**

Exhibit.

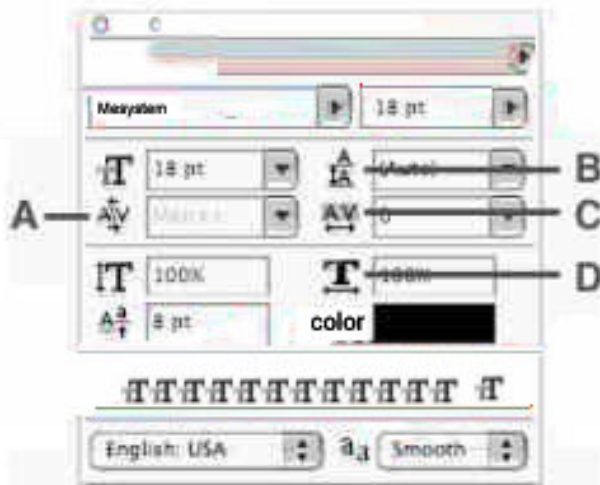

Which Character palette option controls kerning?

- A.A
- B.B
- C.C
- D.D

Answer: A

---

**QUESTION 7:**

You have selected the Type tool. You want to create a new type layer overlapping a previous one. What should you do?

- A. double click with the Type tool
- B. hold down the Shift key as you click with the Type tool

- C.holddown the Option (Mac OS) or Alt (Windows) key as you click with the Type tool.
- D.Hold down the Command (Mac OS) or Ctrl (Windows) key as you click with the Type tool.

Answer: B

---

**QUESTION 8:**

Exhibit.



You have created type on a path. You want to move the type along the path. Which tool (s) should you sue to drag the type?

- A.Move tool
- B.Path Type tool
- C.Horizontal or Vertical Type tool
- D.Path Selection or Direct Selection tool

Answer: D

---

**QUESTION 9:**

Exhibit.

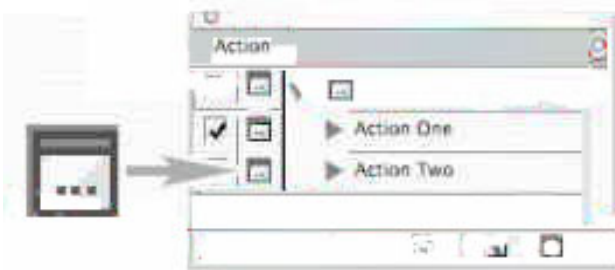

In the exhibit, what does the icon on the left indicate?

- A.that the action is currently being recorded
- B.that all the steps in the action offer the user a dialog box
- C.that one or more, but not all, steps in the action offer the user a dialog box
- D.that the action is currently paused in playback, waiting for a response from the user

Answer: C

---

**QUESTION 10:**

You are applying an action to a group of images using the Batch command. The action contains a SaveAs TIFF command, with specific options chosen. You want the processed files to be saved with those options, but to be renamed.

Which two options in the Batch dialog box should you choose? (Choose two.)

- A.Batch Rename
- B.Destination: Folder
- C.Include All Subfolders
- D.Destination: Save and Close
- E.Override Action "Save As" Commands

Answer: AB

---

### **QUESTION 11:**

You are recording an action. During its playback, you want an image's magnification to be adjusted to fit the image on screen.

What should you do?

- A.choose View > Fit on Screen
- B.when you get to the point for the magnification change, choose View > Fit on Screen
- C.use the Insert Menu Item command from the Action palette menu, then choose View > Actual Pixels
- D.Use the Insert Menu Item command from the Action palette menu, then choose View > Fit on Screen

Answer: D

---

### **QUESTION 12:**

Exhibit.



The three images in the exhibit were scanned together. You apply the File>Automate>Crop and Straighten Photos command.

What is the result?

- A.A separate layer is created for each image, excluding the white border, and each is rotated to correct for its crookedness.
- B.A separate layer is created for each image, including some white border, and each is rotated to correct for its

crookedness.

C.A separate document is created for each image, excluding the white border, and each is rotated to correct for its crookedness.

D.A separate document is created for each image, including some white border, and each is rotated to correct for its crookedness.

Answer: C

---

**QUESTION 13:**

You want to modify the tonal range of an image without permanently affecting the pixels.

What should you do?

A.use Variations

B.use Auto Levels

C.use a layer style

D.use an adjustment layer

Answer: D

---

**QUESTION 14:**

What would you most likely need to do after resampling a 20 megabyte image to 100 kilobytes using Bicubic Interpolation?

A.Blur

B.Sharpen

C.Add Noise

D.Auto Levels

Answer: B

---

**QUESTION 15:**

Which option in the Auto Color Correction Options dialog box preserves the overall color relationship while making highlights appear lighter and shadows appear darker?

A.Snap NeutralMidtones

B.Find Dark & Light Colors

C.Enhance Per Channel Contrast

D.Enhance Monochromatic Contrast

Answer: D

---

**QUESTION 16:**

You are trying to lighten only the darkest shadows in an image by choosing Image > Adjustments > Shadow/Highlight. You notice that lighter areas are being affected as well.

What should you do?

- A.increase the Radius setting
- B.decrease the Radius setting
- C.increase the Tonal Width setting
- D.decrease the Tonal Width setting

Answer: D

---

**QUESTION 17:**

You are working in the Levels dialog box. The pixels in the image cover a range from 0-220. You want to increase the contrast in the highlight areas of the image.

What should you do?

- A.increase the value for the black Input Level
- B.decrease the value for the white Input Level
- C.increase the value for the black Output Level
- D.decrease the value for the white Output Level

Answer: B

---

**QUESTION 18:**

You are using the Shadow/Highlight command to correct an underexposed image.

Which value determines the scale size for corrections?

- A.Radius
- B.Amount
- C.Tonal Width
- D.MidtoneContrast

Answer: A

---

**QUESTION 19:**

An overexposed photograph has nearly no detail in its highlights, but otherwise has acceptable tonal balance.

Which option from the Image > Adjustments menu should you use to reveal the details in the highlights?

- A.Gradient Map
- B.Channel Mixer

- C.Shadow/Highlight
- D.Brightness/Contrast

Answer: C

---

**QUESTION 20:**

You want to create a diagonal elliptical marquee.  
What should you do?

- A.hold down the spacebar and rotate the marquee while dragging with the Elliptical Marquee tool
- B.create a marquee with the Elliptical Marquee tool, then rotate it by choosing Edit > Free Transform
- C.create a marquee with the Elliptical Marquee tool, then rotate it by choosing Select > Transform Selection
- D.While dragging with the Elliptical Marquee tool, hold down Alt (Windows) or Option (Mac OS) and rotate the marquee

Answer: C

---

**QUESTION 21:**

You have a photo of a green leaf. The leaf is in sharp focus and is against a blurred green background.  
You want to make a selection that follows the contour of the leaf.  
What should you do?

- A.use the Find Edges filter
- B.use the Magic Wand tool
- C.use the Magnetic Lasso tool
- D.choose Select >ColorRange

Answer: C

---

**QUESTION 22:**

You have saved a selection as a channel. You now want to load and reuse the selection.  
What should you do?

- A.drag the alpha channel into the image window
- B.Alt (Windows) or Option (Mac OS) click on the alpha channel
- C.Ctrl (Windows) or Command (Mac OS)click on the alpha channel
- D.Right-click (Windows) or Control-click (Mac OS) on the channel and choose Load Channel as Selection

Answer: C

---

**QUESTION 23:**

You have created a rough selection of an object in your image. You want to refine the selection by using



quick mask with its default settings and the Brush tool.  
Which statement is true?

- A.Painting with white adds to the selection
- B.Painting with black adds to the selection.
- C.The opacity setting of the brush is irrelevant.
- D.The foreground color must be either black or white.

Answer: A

---

**QUESTION 24:**

You have made a feathered selection. You then repeatedly fill the selected area with different colors.  
Which statement is true?

- A.Traces of the earlier color fills remain at the feathered edges of the selection.
- B.At the feathered edges of the selection only the image's luminosity is affected, not its hue or saturation.
- C.At the feathered edges of the selection only the image's hue and saturation are affected, not its luminosity.
- D.Though fading in opacity at the feathered edges of the selection, the newer fills completely overwrite the earlier ones.

Answer: A

---

**QUESTION 25:**

Exhibit.



Which tool can completely eliminate the white pixels in the background of the image shown in the exhibit with a single click?

- A.Eraser
- B.Extract

- C.Magic Eraser
- D.Color Replacement

Answer: C

---

**QUESTION 26:**

You have been editing an image. You want to restore certain small areas of the image to their condition before your last several edits.

Which tool or command should you use?

- A.Eraser tool
- B.Edit > Undo
- C.History Brush tool
- D.Edit > Step Backward

Answer: C

---

**QUESTION 27:**

You are using the Pattern Stamp tool to paint in your image.

Which tool option ensures that the pattern is applied continuously, rather than from the initial sampling point, regardless of how many times you stop and resume painting with the pattern?

- A.Flow
- B.Aligned
- C.Impressionist
- D.Protect Texture

Answer: B

---

**QUESTION 28:**

Exhibit.

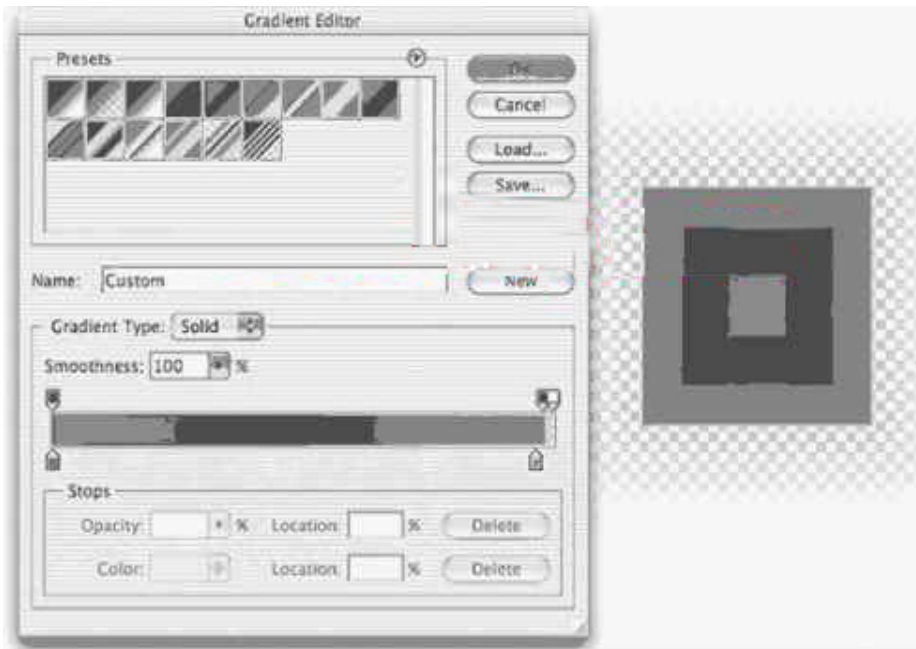

In the exhibit, which gradient was used to create the result to the right?

- A.Angle Gradient
- B.Radial Gradient
- C.Diamond Gradient
- D.Reflected Gradient

Answer: C

---

### QUESTION 29:

Which option from the Brushes palette allows you to determine the number and placement of marks in a stroke?

- A.Texture
- B.Scattering
- C.Shape Dynamics
- D.Brush Tip Shapes

Answer: B

---

### QUESTION 30:

Exhibit.



You want to create a shape layer by drawing in a freeform manner.

Which two buttons from the Vector Tools Options Bar should you choose? (Choose two.)

- A.A
- B.B
- C.C
- D.D
- E.E

Answer: A, D

Explanation:

Not A, B: You simply cannot choose both A and B at once. A is the shape layer tool and will place a shape layer in the layer palette (>window >layer)if choosen with any of the tools on the right. Answer D is called the freeform pen tool and is designed specifically to draw freehand. So the answer has to be A and D.

---

**QUESTION 31:**

Exhibit.



You want to create a work path by using one of the built-in custom shapes.

Which two buttons from the Vector Tools Options Bar should you choose? (Choose two.)

- A.A
- B.B
- C.C
- D.D
- E.E

Answer: B, E

Explanation:

Not A, B: No matter what control/alt/shift keys (or any combination) you hold down, you can't choose both answers A and B.

Answer B is the paths tool and will place a workpath on the paths palette (>window >paths) Answer E, is the only answer that is a custom shape. The answer has to be B and E. Answer A is a wrong because it is the shape layer tool and will place a VECTOR PATH on the paths palette.

---

**QUESTION 32:**

You have drawn a patch in your image. In the Paths palette, the path name is Work Path.

What happens if you deselect Work Path and draw and new path?

- A.The new path is added to Work Path.
- B.A new path called Work Path 2 is created.
- C.A single path component is created from all overlapping components.
- D.The original Work Path is deleted, and the new path becomes Work Path.

Answer: D

---

**QUESTION 33:**

You have selected several anchor points of a shape layer. You want to rotate them an arbitrary amount. Which command should you use?

- A.Filter >Liquify
- B.Edit > Free Transform Path
- C.Edit > Free Transform Points
- D.Layer > Change Layer Content

Answer: C

---

**QUESTION 34:**

Which file format can preserve vector data?

- A.BMP
- B.PICT
- C.Photoshop PDF
- D.Photoshop RAW

Answer: C

---

**QUESTION 35:**

Exhibit.

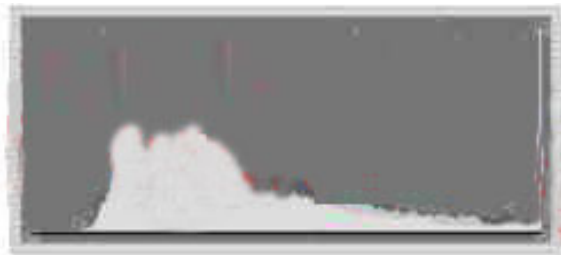

You are using Camera RAW to import an image. You want the leftmost data in the histogram to be farther to the left with little effect on the right. Which slider under the Adjust tab should you use?

- A.Contrast
- B.Shadows
- C.Exposure

D.Brightness

Answer: B

---

**QUESTION 36:**

You are creating a graphic that is to be used in an Anamorphic(2:1) video product. You use the Ellipse tool while holding down the Shift key. Pixel Aspect Ratio Correction preview is disabled. How does the result appear in Photoshop?

- A.a circle with pixels twice as tall as they are wide
- B.a circle with pixels twice as wide as they are tall
- C.all ellipse twice as tall as it is wide with square pixels
- D.an ellipse twice as wide as it is tall with square pixels

Answer: C

---

**QUESTION 37:**

While opening a Camera Raw image, you notice that the image has a slight color cast. Which setting in the Camera Raw dialog box should you adjust to eliminate the color cast?

- A.Calibrate
- B.Color Space
- C.White Balance
- D.Chromatic Aberration R/C

Answer: C

---

**QUESTION 38:**

What is the purpose of setting a pixel aspect ratio for an image?

- A.to draw perfect squares or circles with the Marquee tool
- B.to constrain the proportions of an image when it is scaled
- C.to ensure that the resolution of the image is appropriate for printing
- D.to compensate for scaling when the image is incorporated into video

Answer: D

---

**QUESTION 39:**

You are using the Unsharp Mask filter on a portrait. You want to avoid sharpening imperfections in the skin tone. What should you do?

- A.increase the Amount setting
- B.decrease the Amount setting
- C.increase the Threshold setting
- D.decrease the Threshold setting

Answer: C

---

**QUESTION 40:**

Using Filter Gallery, you want to preview the effect of applying several distortion and artistic filters. Which statement is true?

- A.You can adjust the opacity of each filter layer.
- B.You can preview the filters' effect on more than one layer at a time.
- C.You can add more filters in those categories with the Preset Manager.
- D.You can change the order in which the filters will be applied before applying the gallery.

Answer: D

---

**QUESTION 41:**

Which tool should you use to repair a portion of an image so that texture detail from one area of an image merges with the color and brightness values from another?

- A.Clone Stamp
- B.History Brush
- C.Healing Brush
- D.Color Replacement

Answer: C

---

**QUESTION 42:**

Exhibit: \*\*\* MISSING \*\*\*

You have made a selection of an area of an image you need to repair. Using the Patch tool, you want to drag the selection to the area that will serve as a patch.

Which Patch tool option should you choose?

- A.A
- B.B
- C.C
- D.D

Answer: A

---

**QUESTION 43:**

You foreground swatch is red, you background swatch is orange. Wherever you paint, you want to replace only orange with red. You do NOT want to affect luminosity values.

Which tool should you use?

- A.Brush tool
- B.Magic Eraser tool
- C.Art History Brush tool
- D.Color Replacement tool

Answer: D

---

**QUESTION 44:**

An image with a correctly assigned input profile has been converted to Adobe RGB (1998).

Which statement is true?

- A.The colors look different, but the color numbers are identical.
- B.The colors look different and the color numbers are different.
- C.The colors look the same, but the color numbers are different.
- D.The colors look the same and the color numbers are identical.

Answer: C

---

**QUESTION 45:**

Which term is used to describe how a particular device currently reproduces color?

- A.calibrating
- B.soft proofing
- C.synchronizing
- D.characterizing

Answer: D

---

**QUESTION 46:**

What is the purpose of the Proof Setup command?

- A.to correctly display an image that uses non-square pixels
- B.to tag an image with a profile that describes its color space
- C.to preview how the image will print to the current printer and paper size
- D.to preview on screen how a file will display or print on different output devices

Answer: D



---

**QUESTION 47:**

Which rendering intent is suitable for business graphics, where maintaining the exact relationship between colors is not as important as creating vivid color?

- A.Saturation
- B.Perceptual
- C.Relative Colorimetric
- D.Absolute Colorimetric

Answer: A

---

**QUESTION 48:**

In the Color Settings dialog box, where do you specify the color profile that you want to use for each color model?

- A.Working Spaces
- B.Advanced Controls
- C.Conversion Options
- D.Color Management Policies

Answer: A

---

**QUESTION 49:**

Which file format support vector graphics?

- A.GIF
- B.PDF
- C.PNG
- D.JPEG

Answer: B

---

**QUESTION 50:**

A digital camera supported by Adobe Photoshop was set for tungsten lighting when a photograph was made in daylight. The photograph was made in the camera's RAW mode. What should you do?

- A.when opening the document, adjust the tint slider in the Camera RAW dialog box
- B.after opening the document, use the Assign Profile dialog box to the chooseProPhotoRGBIcprofile
- C.after opening the document, use the Color Settings dialog box to the chooseProPhotoRGBIcprofile
- D.when opening the document, choose daylight under the White Balance menu in the Camera RAW dialog box

Answer: D

---

**QUESTION 51:**

You have created a shape layer. You want to sue a filter on the shape.  
What must you do?

- A.delete the layer mask
- B.delete the vector mask
- C.resterizethe fill content
- D.rasterizethe shape layer

Answer: D

---

**QUESTION 52:**

Which statement about using the Place command to place anIIIustratorfile into a Photoshop document is true?

- A.It becomes a shape layer.
- B.It israsterizedat the document's resolution.
- C.It becomes a link to the originalIIIustratorfile.
- D.It becomes a working path in the Paths palette.

Answer: C

---

**QUESTION 53:**

Which file format should you use to preserve variable transparency in an image to be used on a web page?

- A.GIF
- B.TIFF
- C.PNG
- D.JPEG

Answer: C

---

**QUESTION 54:**

How do you apply keywords to many images in a directory?

- A.use the Preset Manager
- B.use the File info keyword field
- C.use the File Browser keyword tab

D.check "Enable Version Cue Workgroup File Management" in the File Handling preferences

Answer: C

---

**QUESTION 55:**

You want to print a document with shape layers. You want the vector data to be sent to a Postscript printer.

What should you do?

- A.duplicate the shape layers' vector masks as paths
- B.choose Layer >Rasterize> All Layers before printing
- C.select Maximize Compatibility in the File Handling Preference dialog box
- D.select Include Vector Data in the Output options of the Print with Preview dialog box.

Answer: D

---

**QUESTION 56:**

Which command should you use to print an image by using the current print settings WITHOUT displaying a dialog box?

- A.Print
- B.Page Setup
- C.Print One Copy
- D.Print with Preview

Answer: C

---

**QUESTION 57:**

You want print a document in duotone mode to your four-color desktop inkjet printer.

Which statement is true?

- A.Only two inks will be used by the printer.
- B.The image will print in grayscale, using black ink only.
- C.The image will print as a process color approximation on the document.
- D.Each of the inks specified in the duotone will be replaced by a pair of inks at the printer.

Answer: C

---

**QUESTION 58:**

Which statement about printing duotones is true?

- A.Duotones must be converted to CMYK mode before printing.

- B.A transfer function should be created for each ink in the duotone.
- C.The inks used in duotones must be printed a different screen angles.
- D.Duotones should be saved as TIFF files if they are going to be imported into and printed from a page-layout application.

Answer: C

---

**QUESTION 59:**

You are printing an image from Photoshop. You want Photoshop to handle the color management. Which options should you choose for Print Space from the Color Management area of the Print with Preview dialog box?

- A.Same as Source
- B.a profile of your printer
- C.a profile of your monitor
- D.Printer Color Management

Answer: B

---

**QUESTION 60:**

You are creating an interface element with a drop shadow for a Web page. You want to maintain the full, variable transparency of the graphic and shadow. You enable transparency in the Save for Web dialog box. Which file format renders the transparency without introducing a surrounding matte color?

- A.GIF
- B.JPEG
- C.PNG8
- D.PNG24

Answer: D

---

**QUESTION 61:**

Which file format should you sue display photographs and other continuous-tone images on the Web?

- A.GIF
- B.TIFF
- C.PDF
- D.JPEG

Answer: D

---

**QUESTION 62:**

You have a single layered document. You want to generate a JPEG of a small area of the document. What should you do?

- A.Copy that area to a new layer, disable the visibility of the original layer, then use the Save for Web dialog box
- B.Save a selection of the area as a channel, then click the Alpha channel button in the Save for Web dialog box
- C.Create a slice of that area, then choose All User Slices from the Slice pop-up menu of the Save Optimized AS dialog box
- D.Create a marquee of that area, then choose All User Slices from the Slices pop-up menu of the Save Optimized As dialog box

Answer: C

---

**QUESTION 63:**

You have created a navigation bar for a Website that contains both continuous-tone images and areas of flat color. You want to achieve the best optimization for the navigation bar. What should you do?

- A.save the image as a GIF
- B.save the image as JPEG
- C.create slices to determine how areas should be optimized
- D.create image maps to determine how areas should be optimized

Answer: C

---

**QUESTION 64:**

You have created a graphic that you will be suing on the Web. The graphic includes transparent areas. You want the fully transparent pixels to remain transparent, and you want to blend partially transparent pixels with a color. What optimization options should you choose?

- A.select transparency, and select a matter color
- B.deselect transparency, and select a matter color
- C.select transparency, and set the matte color to None
- D.deselect transparency, and set the matte color to None

Answer: A

---

**QUESTION 65:**

What happens when you choose the command Layer > Flatten image?

- A.Layers within layer sets are merged into a single layer.
- B.All layers are made visible and then combined into the background layer.
- C.The active layer and all visible layers below it are combined into a single layer.
- D.All visible layers are combined into the background layer and hidden layers are discarded.

Answer: D

---

**QUESTION 66:**

You have created a layer set. You want to maintain the blending modes that are assigned to the individual layers within the set.

Which blending mode should you use for the layer set?

- A.Normal
- B.Multiply
- C.Overlay
- D.Pass Through

Answer: D

---

**QUESTION 67:**

How do you hide the content of several layer sets with one mask?

- A.put all of the layer sets inside a new layer set, select this new set, then click the Add Mask button
- B.create a clipping mask consisting of the layer sets, select the base set in that group, and click the Add Mask button.
- C.create a layer above the layer sets, set its Fill Opacity to 0%, and its Knockout setting to Deep
- D.create a layer above the layer sets, set its Fill Opacity to 0%, and its Knockout setting to Shadow

Answer: A

---

**QUESTION 68:**

You want to give the content of a layer a textured appearance (relief) that responds to the Global Angle of light.

Which layer style should you use?

- A.Satin
- B.Pattern Overlay
- C.Gradient Overlay
- D.Bevel and Emboss

Answer: D

---

**QUESTION 69:**

The topmost of several layers in a document is a shape layer. You want that shape to define a hole in all the layers of the image.

What should you do?

- A.select the top layer, and choose Layer > Create Clipping Mask
- B.link all layers, then choose Layer > Create Clipping Mask from Linked
- C.in the top layer's Blending Options, set the Opacity to 0%, and knockout to Deep
- D.in the top layer's Blending Options, set the Fill Opacity to 0%, and knockout to Deep

Answer: D

---

**QUESTION 70:**

Which mask does a shape layer use by default?

- A.vector
- B.raster
- C.clipping
- D.transparency

Answer: A

---

**QUESTION 71:**

You want to create a vector polygon that is filled. You want to be able to move the polygon independently of layers and to apply layer styles to the polygon.

What should you do?

- A.use the Polygon tool to fill pixels
- B.use the Polygon tool to create a path
- C.use the Polygon tool to create a shape layer
- D.use the Polygon tool to create a clipping mask

Answer: C

---

**QUESTION 72:**

You create an alpha channel \_\_\_\_\_.

- A.to hold color data for a document
- B.to create transparency for a layer
- C.to create transparency for a JPEG file
- D.to localize Optimization settings in Save for Web

Answer: D

---

**QUESTION 73:**

You have saved a selection as a channel. You want to modify that channel with a new selection. You want to add white within the newly selected area on the alpha channel. You choose Select > Save Selection. What should you do?

- A.select the alpha channel and click the Add to Channel button
- B.select the alpha channel and click the Exclude Overlapping button
- C.select the alpha channel and click the Intersect with Channel button
- D.select the alpha channel and click the Subtract from Channel button

Answer: A

---

**QUESTION 74:**

Which type of channel stores selections for editing specific parts of an image?

- A.color channels
- B.alpha channels
- C.masking channel
- D.spot color channels

Answer: B

---

**QUESTION 75:**

You want to create an image that will be printed using black ink plus onePantone?color. What should you do?

- A.add a color swatch for thePantone?colorand use the color on any layer
- B.create an alpha channel for the elements that will use thePanatone?color
- C.create a spot color channel for the elements that will use thePanatone?color
- D.create a layer set and add elements that will print in thePantone?colorto any layer within the layer set

Answer: C

---

**QUESTION 76:**

Using Filter Gallery, you want to preview the effect of applying several distortion and artistic filters. Which statement is true?

- A.You can adjust the opacity of each filter layer.
- B.You can preview the filters' effect on more than one layer at a time.



- C.You can add more filters in those categories with the Preset Manager.  
D.You can change the order in which the filters will be applied before applying a gallery.

Answer: D

---

**QUESTION 77:**

Your foreground swatch is red, your background swatch is orange. Wherever you paint, you want to replace only orange with red. You do NOT want affect luminosity values.  
Which tool should you use?

- A.Brush tool  
B.Magic Eraser tool  
C.Art History Brush tool  
D.Color Replacement tool

Answer: D

---

**QUESTION 78:**

Exhibit

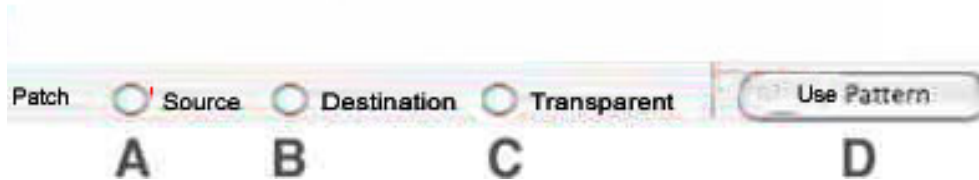

You have made a selection of an area of an image you need to repair. Using the Patch tool, you want to drag the selection to the area that will serve as a patch.  
Which Patch tool option should you choose?

- A.A  
B.B  
C.C  
D.D

Answer: A

---

**QUESTION 79:**

Which tool should you use to repair a portion of an image so that texture detail from one area of an image merges with the color and brightness values from another?

- A.Clone Stamp  
B.History Brush  
C.Healing Brush  
D.Color Replacement

Answer: C

---

**QUESTION 80:**

A scanned photograph exhibits substantial graininess and diminished sharpness. You want to sharpen the image without increasing the grain.

Which control in the UnsharpMask filter should you use?

- A.Fade
- B.Radius
- C.Amount
- D.Threshold

Answer: D

---

**QUESTION 81:**

Which option from the Brushes palette allows you to determine the number and placement of marks in a stroke?

- A.Texture
- B.Scattering
- C.Shape Dynamics
- D.Brush Tip Shapes

Answer: B

---

**QUESTION 82:**

The Aligned checkbox for the Pattern Stamp tool in the Options Bar ensures that \_\_\_\_\_.

- A.all areas painted with the tool are continuations of the same underlying pattern
- B.you are sampling from the same pixels in the pattern with which you are painting
- C.you are sampling from the same relative point in the pattern with which you are painting
- D.the upper left corner of the pattern with which you are painting is aligned with the beginning of each brush stroke

Answer: A

---

**QUESTION 83:**

You have been editing an image. You want to restore certain small areas of the image to their condition before you last several edits.

Which tool or command should you use?

- A.Eraser tool
- B.Edit > Undo
- C.History Brush tool
- D.Edit > Step Backward

Answer: C

---

**QUESTION 84:**

You are creating a layer style that includes a Bevel and Emboss.  
What allows you to sculpt the ridges, valleys, and bumps that are shaded in the embossing process?

- A.spread
- B.contour
- C.shading
- D.blend mode

Answer: B

---

**QUESTION 85:**

You use the Magic Eraser tool on the background.  
What is the result?

- A.The background becomes Layer 0 and the pixels similar in color to the one clicked become transparent.
- B.The background becomes Layer 0 and the pixels similar in color to the one clicked become filled with background color.
- C.The background remains and the pixels similar in color to the one clicked become filled with background color.
- D.The background remains and the pixels similar in color to the one clicked become filled with black.

Answer: A

---

**QUESTION 86:**

You have several layers in a layer set. You want to the layers in that set to blend with one another first,  
and then with the rest of the layers in the document.  
Which blending mode should you use for the layer set?

- A.Normal
- B.Hard Mix
- C.Exclusion
- D.Pass Through

Answer: D

---

**QUESTION 87:**

A Photoshop document has several paths. You want to use one of them as a vector mask.  
What should you do?

- A. choose Layer > Add Vector Mask then choose a path from the resulting dialog box.
- B. select the path in the Paths palette, then choose Layer > Add Vector Mask > Current Path
- C. copy the path to the clipboard, choose Layer > Add Vector Mask; then Edit > Paste
- D. choose Layer > Add Vector Mask, then drag the path from the Paths palette onto the Vector Mask thumbnail

Answer: B

---

**QUESTION 88:**

The topmost of several layers in a document is a shape layer. You want that shape to define a hole in all the layers of the image.  
What should you do?

- A. select the top layer, and choose Layer > Create Clipping Mask
- B. link all layers, then choose Layer > Create Clipping Mask from Linked
- C. in the top layer's Blending Options, set the Opacity to 0%, and Knockout to Deep
- D. in the top layer's Blending Options, set the Fill Opacity to 0%, and knockout to Deep

Answer: D

---

**QUESTION 89:**

You have created a raster layer mask that is currently hiding too much of a layer. You want to reveal more of the layer.  
What should you do?

- A. select the mask and paint with white
- B. select the mask and paint with black
- C. create a path around the area you need to reveal, then create a vector mask
- D. create a path with Intersect Shape Areas selected around the area you need to reveal, then create a vector mask

Answer: A

---

**QUESTION 90:**

You want to restrict the visibility of one layer to only where it overlaps the visible content of the layer below it.  
What should you do?

- A. select the lower of the two layers and choose Layer > Create Clipping Mask

- B.holddown Alt (Windows) or Option (Mac OS) and click on the line between the two layers.
- C.Link the two layers,thenchoose Create New Set from Linked from the Layers palette menu.
- D.Select both layers, then click on the Add Layer Mask button at the bottom of the Layers palette

Answer: B

---

**QUESTION 91:**

You are suing the Shadow/Highlight command to correct an underexposed image.  
Which value determines the scale size for corrections?

- A.Radius
- B.Amount
- C.Tonal Width
- D.MidtoneContrast

Answer: A

---

**QUESTION 92:**

You have several images of a subject. One has the correct tonal and color characteristics. You want to adjust the other to look like the correct one.  
Which option from the Image > Adjustments menu should you use?

- A.Auto Color
- B.Match Color
- C.Replace Color
- D.Selective Color

Answer: B

---

**QUESTION 93:**

What would you most likely need to do afterresamplinga 20 megabyte image to 100 kilobytes using BicubicInterpolation?

- A.Blur
- B.Sharpen
- C.Add Noise
- D.Auto Levels

Answer: B

---

**QUESTION 94:**

The shadows and highlights in a document are too light and too dark respectively. The color of the image,

however, is satisfactory.

Which option in the Auto Color Correction Options dialog box should you choose?

- A.Snap NeutralMidtones
- B.Find Dark & Light Colors
- C.Enhance Per Channel Contrast
- D.Enhance Monochromatic Contrast

Answer: D

---

### QUESTION 95:

Exhibit.

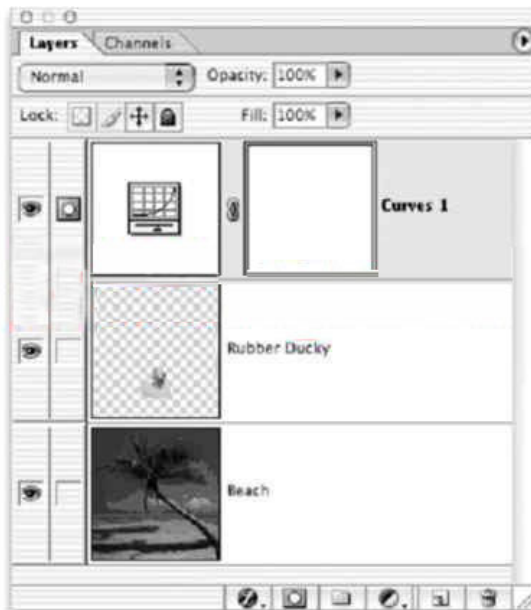

You have created a curves adjustment layer that you only want applied to the Rubber ducky layer. You notice that the adjustment layer darkens the entire composition. What should you do?

- A.put the beach layer above the adjustment layer
- B.create a clipping mask with the Rubber Ducky layer
- C.put the Rubber Ducky layer above the adjustment layer
- D.create a layer set with the adjustment and Rubber Duckylaers

Answer: B

---

### QUESTION 96:

You are trying to lighten a dark subject in your image by using the Shadow/Highlight command, but the midtones and lighter areas are changing too much.

What should you do?

- A.increase the Shadow Amount
- B.decrease the Shadow Amount
- C.Increase the Shadow Tonal Width
- D.Decrease the Shadow Tonal Width

Answer: D

---

**QUESTION 97:**

You are working in the Levels dialog box. The pixels in the image cover a range from 0-220. You want to increase the contrast in the highlight areas of the image.

What should you do?

- A.increase the value for the black Input Level
- B.decrease the value for the white Input Level
- C.increase the value for the black Output Level
- D.decrease the value for the white Output Level

Answer: B

---

**QUESTION 98:**

Exhibit.



You are using Camera RAW to import an image. You want the leftmost data in the histogram to be farther to the left with little effect on the right.

Which slider under the Adjust tab should you use?

- A.Contrast
- B.Shadows
- C.Exposure
- D.Brightness

Answer: B

---

**QUESTION 99:**

While opening a Camera Raw image, you notice that the image has a slight color cast.

Which setting in the Camera Raw dialog box should you adjust to eliminate the color cast?

- A.Calibrate
- B.Color Space

- C.White Balance
- D.Chromatic Aberration R/C

Answer: C

---

**QUESTION 100:**

What is the purpose of setting a pixel aspect ratio for an image?

- A.to draw perfect squares or circles with the Marquee tool
- B.to constrain the proportions of an image when it is scaled
- C.to ensure that the resolution of the image is appropriate for printing
- D.to compensate for scaling when the image is incorporated into video

Answer: D

---

**QUESTION 101:**

You are creating a graphic that is to be used in an Anamorphic(2:1) video product. You use the Ellipse tool while holding down the Shift key. Pixel Aspect Ratio Correction preview is disabled. How does the result appear in Photoshop?

- A.a circle with pixels twice as tall as they are wide
- B.a circle with pixels twice as wide as they are tall
- C.an ellipse twice as tall as it is wide with square pixels
- D.an ellipse twice as wide as it is tall with square pixels

Answer: C

---

**QUESTION 102:**

You create an alpha channel \_\_\_\_\_.

- A.to hold color data for a document
- B.to create transparency for a layer
- C.to create transparency for a JPEG file
- D.to localize Optimization settings in Save for Web

Answer: D

---

**QUESTION 103:**

Which type of channel stores selections for editing specific parts of an image?

- A.color channels
- B.alpha channels



- C.masking channel
- D.spot color channels

Answer: B

---

**QUESTION 104:**

You want to create an image that will be printed using black ink plus onePantone?Color.  
What should you do?

- A.add a color swatch for thePantone?colorand use the color on any layer
- B.create an alpha channel for the elements that will use thePantone?color
- C.create a spot color channel for the elements that will use thePantone?color
- D.create a layer set and add elements that will print in thePanatone?colorto any layer within the layer set

Answer: C

---

**QUESTION 105:**

You have saved a selection as a channel. You want to modify that channel with a new selection. You want to add white within the newly selected area on the alpha channel. You choose Select > Save Selection.  
What should you do?

- A.select the alpha channel and click the Add to Channel button
- B.select the alpha channel and click the Exclude Overlapping button
- C.select the alpha channel and click the Intersect with Channel button
- D.select the alpha channel and click the Subtract from Channel button

Answer: A

---

**QUESTION 106:**

You have used the File Browser to rotate, flag, and rank images in a directory. You want to burn the entire directory to a CD while maintaining the settings in the File Browser.  
Which File Browser command should you use?

- A.File > Purge Cache
- B.File > Export Cache
- C.Edit > Append Metadata
- D.Edit > Replace Metadata

Answer: A

---

**QUESTION 107:**

Yourasterizea type layer to \_\_\_\_\_.

- A.use Liquify
- B.apply all layer style
- C.use Free Transform
- D.use an adjustment layer

Answer: A

---

**QUESTION 108:**

Which statement is true about using the command File > Place to place artwork in an image?

- A.The artwork will be placed on a new layer.
- B.You can choose to place the artwork as pixels or paths.
- C.You can choose which resolution to use for the imported artwork.
- D.The file formats you can place are the same as those in which you can save a Photoshop file.

Answer: A

---

**QUESTION 109:**

A digital camera supported by Adobe Photoshop was set for tungsten lighting when a photograph was made in daylight. The photograph was made in the camera's RAW mode. What should you do?

- A.when opening the document, adjust the tint slider in the Camera RAW dialog box
- B.after opening the document, use the Assign Profile dialog box to choose ProPhoto RGB color profile
- C.after opening the document, use the Color Settings dialog box to choose ProPhoto RGB color profile
- D.when opening the document, choose daylight under the White Balance menu in the Camera RAW dialog box

Answer: D

---

**QUESTION 110:**

Which file format should you use to preserve variable transparency in an image to be used on a web page?

- A.GIF
- B.TIFF
- C.PNG
- D.JPEG

Answer: C

---

**QUESTION 111:**

Which file format supports vector graphics?

- A.GIF
- B.PDF
- C.PNG
- D.JPEG

Answer: B

---

**QUESTION 112:**

Exhibit.

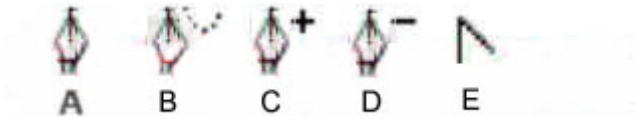

You want to convert one anchor point from one that gives curvature to a path to one that forms a corner. Which tool should you use?

- A.A
- B.B
- C.C
- D.D
- E.E

Answer: E

Explanation:

Answer E is the convert anchor point tool. It is a tool designed specifically to convert anchor points from smooth curves to corners. See Adobe Photoshop help.....search "To convert between a smooth anchor point and a corner anchor point".

---

**QUESTION 113:**

Which file format can preserve vector data?

- A.BMP
- B.PICT
- C.Photoshop PDF
- D.Photoshop RAW

Answer: C

---

**QUESTION 114:**

Exhibit.

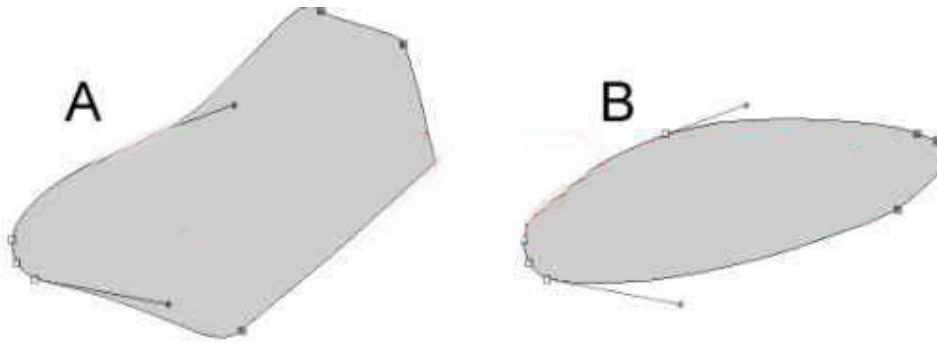

Which command was used to create shape B from shape A?

- A. Effect > Transform > Warp
- B. Edit > Free Transform Points
- C. Select > Transform Selection
- D. Layer > Change Layer Content

Answer: A

---

**QUESTION 115:**

From the Export menu, in which format can you export paths from Photoshop?

- A. Adobe Illustrator (AI)
- B. Enhanced Metafile (EMF)
- C. AutoCAD Drawing
- D. Encapsulated Postscript (EPS)

Answer: A

---

**QUESTION 116:**

Exhibit.



Which tool should you use to move the selected anchor point?

- A. Pen tool
- B. Selection tool
- C. Freeform Pen tool
- D. Direct Selection tool

Answer: D

Explanation:

Not A: With the pen tool you can't move an anchor point.

---

**QUESTION 117:**

You are recording an action. During its playback, you want an image's magnification to be adjusted to fit the image on screen.

What should you do?

- A. choose View > Fit on Screen
- B. when you get to the point for the magnification change, choose View > Fit on Screen
- C. use the Insert Menu Item command from the Action palette menu, then choose View > Actual Pixels
- D. use the Insert Menu Item command from the Action palette menu, then choose View > Fit on Screen

Answer: D

---

**QUESTION 118:**

You assign a color to an action while creating the action.

When is this color used?

- A. to fill a selection when the action is played
- B. when a Function key has been assigned to the Action
- C. when actions are displayed in Button mode in the Actions palette
- D. to highlight the Action name when Playback Options are set to Step by Step

Answer: A

---

**QUESTION 119:**

The command File > Automate > Fit image \_\_\_\_\_.

- A. resamples an image to within specified dimensions
- B. resamples an image to match another open document
- C. resizes an image to within specified dimensions without resampling
- D. resizes an image to match another open document without resampling.

Answer: A

---

**QUESTION 120:**

You want to apply an action to some documents in a folder, but not to all of them.

What should you do?

- A.in the File Browser, first select the individual files, then choose Automate > Batch with File Browser specified as the source
- B.open all of the documents to be processed, then choose All opened Files from the Actions palette menu Playback Options
- C.in the File Browser, first select the individual files, then choose Automate > Batch with Opened Files specified as the source
- D.in the File > Open dialog box, select the individual files, then choose Automate > Batch with import specified as the source

Answer: A

---

**QUESTION 121:**

You are creating an interface element with a drop shadow for a Web page. You want to maintain the full, variable transparency of the graphic and shadow. You enable transparency in the Save for Web dialog box.

Which file format renders the transparency without introducing a surrounding matte color?

- A.GIF
- B.JPEG
- C.PNG8
- D.PNG24

Answer: D

---

**QUESTION 122:**

You have created graphic that you will be using on the Web. The graphic includes transparent areas. You want the fully transparent pixels to remain transparent, and you want to blend partially transparent pixels with a color.

Which optimization options should you choose?

- A.select transparency, and select a matte color
- B.deselect transparency, and select a matte color
- C.select transparency, and set the matte color to None
- D.deselect transparency, and set the matte color to None

Answer: A

---

**QUESTION 123:**

You have created a navigation bar for a Website that contains both continuous-tone images and areas of flat color. You want to achieve the best optimization for the navigation bar.

What should you do?

- A.save the image as a GIF
- B.save the image as a JPEG
- C.create slices to determine how areas should be optimized
- D.create image maps to determine how areas should be optimized

Answer: C

---

**QUESTION 124:**

You have a single layered document. You want to generate a JPEG of a small area of the document. What should you do?

- A.Copy that area to a new layer, disable the visibility of the original layer, then use the Save for Web dialog box
- B.Save a selection of that area as a channel, then click the Alpha channel button in the Save for Web dialog box
- C.Create a slice of that area, then choose All User Slices from the Slices pop-up menu of the Save Optimized AS dialog box
- D.Create a marquee of that area, then choose All User Slices from the Slices pop-up menu of the Save Optimized AS dialog box

Answer: C

---

**QUESTION 125:**

Which file format should you use to display photographs and other continuous-tone images on the Web?

- A.GIF
- B.TIFF
- C.PDF
- D.JPEG

Answer: D

---

**QUESTION 126:**

You have created a number of Layer Comps.

Which action can be performed WITHOUT causing a warning flat to be displayed in the Layer Comps palette?

- A.moving layers
- B.merging layers
- C.deleting layers
- D.changing color mode

Answer: A

---

**QUESTION 127:**

You want to create several colors to use in a number of projects. You want to save the new colors independent of the defaults so that you can load them at any time.

What should you do?

- A.addthe new colors to the Color palette, then choose Save Colors from the Colors palette menu.
- B.Add the new colors to the Swatches palette,thenchoose Save Swatches from the Swatches palette menu.
- C.Add the new colors to the Color palette, then from the Presets Manager, Shift-click on the new colors and click Save Set
- D.Add the new colors to the Swatches palette, then from the Presets Manager, Shift-click on the new swatches and click Save Set

Answer: D

---

**QUESTION 128:**

You want to paint on a layer by using the Brush tool with an opacity setting of 50%.

Where do you change the opacity setting?

- A.Status Bar
- B.Layer palette
- C.Brushes palette
- D.Tool Options Bar

Answer: D

---

**QUESTION 129:**

Which parameter can you monitor in the Status Bar?

- A.the name of the active layer
- B.the document's color profile
- C.the name of the active document
- D.the document's modification date

Answer: B

---

**QUESTION 130:**

You share your workstation with other Photoshop users.

Which command should you use to preserve your preferred palette configuration?

- A.View>New View
- B.Edit > Preset Manager
- C.Window > Workspace > Save Workspace



D.Window > Workspace > Reset Palette Locations

Answer: C

---

**QUESTION 131:**

You have created a selection of a region of an image. You want a selection of only the edge of this region. What should you do?

- A.choose Filter > Stylize > Find Edges
- B.choose Select > Modify > Border and enter the width of the edge selection
- C.choose Select > Transform Selection and hold the Alt (Windows) or Option (Mac OS) key
- D.choose Select > Inverse while holding down Shift and Alt (Windows) or Shift and Option (Mac OS)

Answer: B

---

**QUESTION 132:**

After making a feathered selection, you choose Layer > New > Layer via Copy. Which statement is true?

- A.The edges of the new layer fade to white from the center outward.
- B.The edges of the new layer fade to black from the center outward.
- C.The edges of the new layer fade in opacity from the center outward.
- D.The edges of the new layer cut from opaque to transparent at the midpoint of the applied feather.

Answer: C

---

**QUESTION 133:**

You want to change the color of the quick mask from its default to a different color. What should you do?

- A.change the foreground color to the desired color before entering quick mask mode
- B.change the background color to the desired color before entering quick mask mode
- C.double click the quick mask icon near the bottom of the toolbox, then click the color box
- D.while in quick mask mode, click on the masked pixels with the Magic Wand tool, then fill with the desired color

Answer: C

---

**QUESTION 134:**

You have made and saved a selection as an alpha channel. You make another selection that overlaps a portion of the alpha channel selection you saved. You want a selection of only the overlapping region. What should you do?

- A.choose Select > Load Selection, choose the overlapping alpha channel, and select Add to Selection
- B.hold down the Shift key while Ctrl (Windows) or Command (Mac OS) clicking on the overlapping alpha channel
- C.choose Select > Load Selection, choose the overlapping alpha channel, and select Intersect with Selection
- D.click the Intersect with Selection button in the Options Bar, then Ctrl (Windows) or Command (Mac OS) click the overlapping alpha channel

Answer: C

---

**QUESTION 135:**

The active layer of a document has a layer mask. You want to select the portion of the layer that is visible.

What should you do?

- A.use the Magic Wand and click on the transparent part of the layer
- B.Ctrl (Windows) or Command (Mac OS) click on the layer mask thumbnail in the Layers palette
- C.use the Select > Load Selection command and choose the layer's transparency with Invert checked
- D.use the Select > Load Selection command and choose the layer's transparency with invert unchecked

Answer: B

---

**QUESTION 136:**

You want to print a document with shape layers. You want the vector data to be sent to the Postscript printer.

What should you do?

- A.duplicate the shape layers vector masks as paths
- B.choose Layer >Rasterize> All Layers before printing
- C.select Maximize Compatibility in the File Handling Preference dialog box
- D.select Include Vector Data in the Output options of the Print with Preview dialog box.

Answer: D

---

**QUESTION 137:**

You are printing an image from Photoshop. You want Photoshop to handle the color management. Which option should you choose for Print Space from the Color Management area of the Print with Preview dialog box?

- A.Same as Source
- B.a profile of your printer
- C.a profile of your monitor
- D.Printer Color Management

Answer: B

---

**QUESTION 138:**

Which statement about printing duotones is true?

- A. Duotones must be converted to CMYK mode before printing.
- B. A transfer function should be created for each ink in the duotone.
- C. The inks used in duotones must be printed at different screen angles.
- D. Duotones should be saved as TIFF files if they are going to be imported into and printed from a page-layout application.

Answer: C

---

**QUESTION 139:**

You want to print a document in duotone mode to your four-color desktop inkjet printer. Which statement is true?

- A. Only two inks will be used by the printer.
- B. The image will print in grayscale, using black ink only.
- C. The image will print as a process color approximation of the document
- D. Each of the inks specified in the duotone will be replaced by a pair of inks at the printer.

Answer: C

---

**QUESTION 140:**

Which command should you use to print an image by using the current print settings WITHOUT displaying a dialog box?

- A. Print
- B. Page Setup
- C. Print One Copy
- D. Print with Preview

Answer: C

---

**QUESTION 141:**

You have created a line of text. You want to reduce the amount of space between every character in the line.

What should you do?

- A. decrease the leading

- B.decrease the baseline shift
- C.choose a negative value for kerning
- D.choose a negative value for tracking

Answer: D

---

**QUESTION 142:**

You have crated text on a path.  
What should you do to flip the direction of the text along the path?

- A.click the drag the text with the Move tool
- B.click the drag the text with the Horizontal or Vertical Type tool
- C.use the Path Selection tool to drag the I-Beam across the path
- D.use the Direct Selection tool to drag the I-Beam across the path

Answer: D

---

**QUESTION 143:**

You want to change the default Auto Leading percentage for type.  
What should you do?

- A.choose Justification from the Character palette menu
- B.choose Justification from the Paragraph palette menu
- C.choose the percentage from the Leading menu of the Character palette
- D.choose the percentage from the Leading menu of the Paragraph palette

Answer: B

---

**QUESTION 144:**

An image with a correctly assigned input profile has been converted to Adobe RGB (1998).  
Which statement is true?

- A.The colors look different, but the color numbers are identical.
- B.The colors look different and the color numbers are different.
- C.The colors look the same, but the color numbers are different.
- D.The colors look the same and the color numbers are identical.

Answer: C

---

**QUESTION 145:**

You are preparing images fro the Web.

Which working RGB space should you use?

- A.Apple RGB
- B.ColorMatchRGB
- C.Adobe RGB (1998)
- D.SRGB IEC6 1966-2.1

Answer: D

---

**QUESTION 146:**

You are converting a document from a large gamut profile to a much smaller one. You are more concerned about preserving the visual relationship between colors than exact color matching. Which rendering intent should you use?

- A.Saturation
- B.Perceptual
- C.Relative Colorimetric
- D.Absolute Colorimetric

Answer: A

---

**QUESTION 147:**

What does Proof Setup do?

- A.It configures the options (crop marks, bleed, etc) for the device on which you produce proofs.
- B.It configures options for previewing on your monitor what colors a profiled device will produce.
- C.It configures the options (crop marks, bleed, etc) for the device on which you typically print work.
- D.It configures options (compression,resampling, etc) for producing a PDFProof?ofthe document.

Answer: D

---

**QUESTION 148:**

A photograph as scanned on two scanners, each of which has a valid ICC profile that has been assigned to the scans.

Which statement is true?

- A.The colors in each document look different, but the color numbers are identical.
- B.The colors in each document look different and the color numbers are different.
- C.The colors in each document look the same, but the color numbers are different.
- D.The colors in each document look the same and the color numbers are identical.

Answer: C