

LYING IN SECTION 20, TOWNSHIP 23 SOUTH, RANGE 30 EAST
CITY OF BELLE ISLE, ORANGE COUNTY, FLORIDA

DESCRIPTION:

A PORTION OF GOVERNMENT LOT 2 AND A PORTION OF THE SOUTHWEST QUARTER OF THE NORTHEAST QUARTER OF SECTION 20, TOWNSHIP 23 SOUTH RANGE 30 EAST, ORANGE COUNTY, FLORIDA, BEING DESCRIBED AS FOLLOWS:

[illegible]

THE ABOVE DESCRIBED PARCEL OF LAND CONTAINS 44.956 ACRES MORE OR LESS.

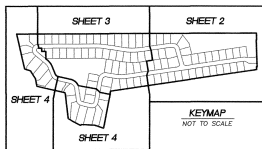

NOTICE: THIS PLAT, AS RECORDED IN ITS GRAPHIC FORM, IS THE OFFICIAL DEPICTION OF THE SUBDIVIDED LANDS DESCRIBED HEREIN AND WILL IN NO CIRCUMSTANCES BE SUPPLANTED IN AUTHORITY BY ANY OTHER GRAPHIC OR DIGITAL FORM OF THE PLAT. THERE MAY BE ADDITIONAL RESTRICTIONS THAT ARE NOT RECORDED ON THIS PLAT THAT MAY BE FOUND IN THE PUBLIC RECORDS OF THIS COUNTY.



1160 Solana Avenue, Winter Park, Florida 32789 (407) 645-1332 LB #5736
04021.049

PLAT BOOK **69** PAGE **12**

BELLE VISTA ON LAKE CONWAY
DEDICATION

KNOW ALL MEN BY THESE PRESENTS, That the Companies named below, being the owners in fee simple of the lands described in the foregoing caption to this plat, do hereby dedicate said lands and plat for the uses and purposes herein expressed and dedicates TRACT D (first station) to ORANGE COUNTY, FLORIDA, and dedicates an INGRESS/EGRESS and EASEMENT TO ORANGE COUNTY, FLORIDA, over TRACT E (right of way) to ORANGE COUNTY UTILITIES, and dedicates the DRAINAGE/UTILITY/ACCESS EASEMENTS shown hereon to the perpetual use of the public. Recording of this plat shall act as conveyance of TRACT D to ORANGE COUNTY, FLORIDA, and no further instrument shall be necessary to vest fee simple title in the COUNTY as aforementioned.

IN WITNESS WHEREOF, I have caused these presents to be signed and attested to by the individual(s) named below on March 20, 2007.

M/A HOMES OF ORLANDO, LLC Signed and sealed in
a Florida limited liability company: the presence of:
By: [Signature] Katherine H. Anderson
Witness Signature
Dana A. Bennett
Regional President Katherine H. Anderson

STATE OF FLORIDA
COUNTY OF ORANGE

SWORN TO and SUBSCRIBED BEFORE ME, by
who is personally known to me or provided
as identification this 22nd day of March, 2007.

Colleen Kay Mabane
NOTARY PUBLIC, STATE OF FLORIDA DD 297178
My commission expires March 8, 2008

IN WITNESS WHEREOF, has caused these presents to be signed and attested to by the individual(s) named below on April 12, 2007

CRITTENDEN FRUIT COMPANY, INC. Signed and sealed in
a Florida limited liability company. the presence of:

Earl M. Crittenden, Jr. Debra B. Townsend
Vice President Witness Signature

STATE OF FLORIDA
COUNTY OF ORANGE

Judy K. Brant
Printed Name

SWORN TO and SUBSCRIBED BEFORE ME, by Earl Crotter Jr
who is personally known to me or provided
as identification this 10th day of April, 2007.

Judy K. Braithwaite
JUDY K. BRAITHWAITE
NOTARY PUBLIC - STATE OF FLORIDA
COMMISSION # 00227950
EXPIRES 8/30/2007
BORN 01/22/1958-ADAMS
NOTARY PUBLIC, STATE OF FLORIDA
My commission expires _____

CERTIFICATE OF APPROVAL BY MUNICIPALITY
THIS IS TO CERTIFY, that on May 2, 2007 the
City Council of the City of Belle Isle approved the foregoing plat.

Mayor, City of BELLE ISLE
 William G. Brooks
 Printed Name

AITEST:
 City Clerk, City of BELLE ISLE
 Belinda L. Bateman
 Printed Name

CERTIFICATE OF APPROVAL BY CITY OF BELLE ISLE
PLANNING AND ZONING COMMISSION

THIS IS TO CERTIFY, that on May 2, 2007
the Planning and Zoning Commission Chairman of the City of BELLE ISLE
approved the foregoing plat.

Signed: Gary M. Rodgers
Planning & Zoning Commission Chairman
Printed Name: Gary M. Rodgers

UNRESERVED DEDICATION

THE CITY OF BELLE ISLE is hereby dedicated the right of entry into perpetuity to reconstruct, repair, inspect, and maintain all facilities on or in dedicated right-of-way which may have been constructed or installed for the public good and welfare, and which may be included any or all of the following: streets, alleys, gutters, curbs, sidewalks, street signs and posts, parks and parkways,

the watermaster management systems located on the property shall be owned or maintained by the Belle Meade on Lake Conway Homeowners' Association. In the event the watermaster management systems are damaged, destroyed, or otherwise become inoperable, maintained, repaired, replaced, or care in accordance with the standards of the Belle Meade on Lake Conway Homeowners' Association shall be the responsibility of the Belle Meade on Lake Conway Homeowners' Association or become a nuisance, the City of Belle Isle shall have the right, but not the obligation, to access, maintain, repair, replace or otherwise become inoperable, maintained, repaired, replaced, or care in accordance with the standards of the Belle Meade on Lake Conway Homeowners' Association. The City of Belle Isle shall own, on a pro rata basis (i.e., per lot), shall be responsible for payment of the cost of the watermaster management systems located on the property. The Belle Isle or its contractors and agents. The City of Belle Isle shall have a lien upon each lot to secure the personal obligation of each lot owner for any unpaid cost and expenses incurred by the City of Belle Isle in connection with the maintenance, repair and the costs of enforcement of such lien. The lien shall be evidenced by a valid and enforceable promissory note, promissory note, Florida's Uniform Code of Creditors' Remedies, and shall be effective from and as of the time of such recording.

CERTIFICATE OF REVIEW BY CITY SURVEYOR
This plot has been reviewed for conformity with Chapter 17
Florida Statutes.
D. B. K. 4/23/07
City Surveyor Date

CERTIFICATE OF APPROVAL BY COUNTY COMPTROLLER

I HEREBY CERTIFY, That I have examined the foregoing plot, and find that it complies in form with all the requirements of Chapter 177, Florida Statutes, and was filed for record on 11/11/2014.

May 8 2007 at _____ County Comptroller, In and for
20070299417 ORANGE County, FLORIDA
MARIA O'HAYNE

Ernest Hansen O.C.

**QUALIFICATION STATEMENT OF
SURVEYOR AND MAPPER**

KNOW ALL MEN BY THESE PRESENTS, That the undersigned, being professional surveyor and mapper that has prepared the foregoing plot was made under my direction and supervision and that the plot complies with all of the survey requirements of Chapter 177, Florida Statutes, that said land is located in the City of DEALE ISLE, Orange County, Florida.

Dated 9/14/07 at ORLANDO, FLORIDA

Seated Surveying Company, Inc. *Robert D. M. Sears*
16100 Solano Avenue
Winter Park, Florida 32789

Witness my hand and seal this _____ day of _____, 2007.
Robert D. M. Sears, P.S.M.
Florida Registration No. 42363
Licensed Business No. 57936